

SO 37887 (Title Plan)

Cpy - 01/01, Pgs - 003, 09/07/07, 11:54



DocID: 410022715

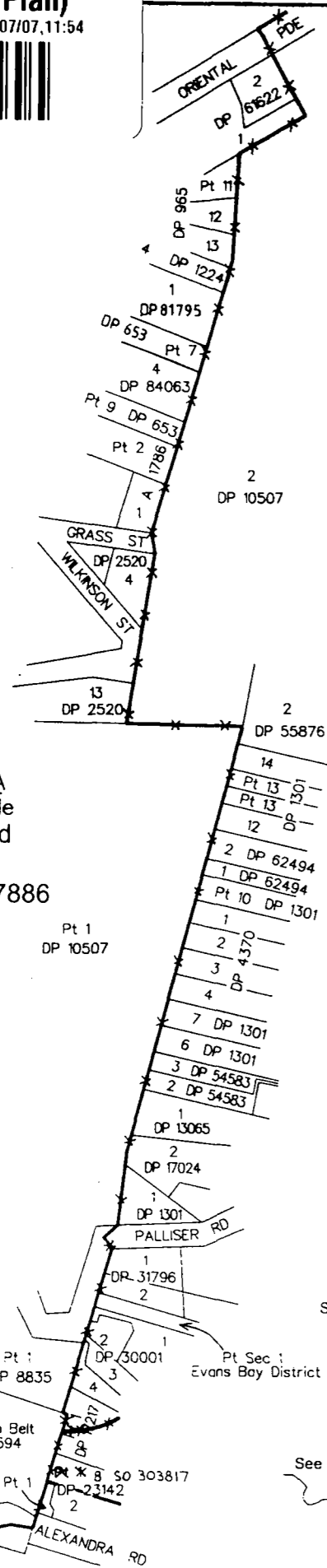
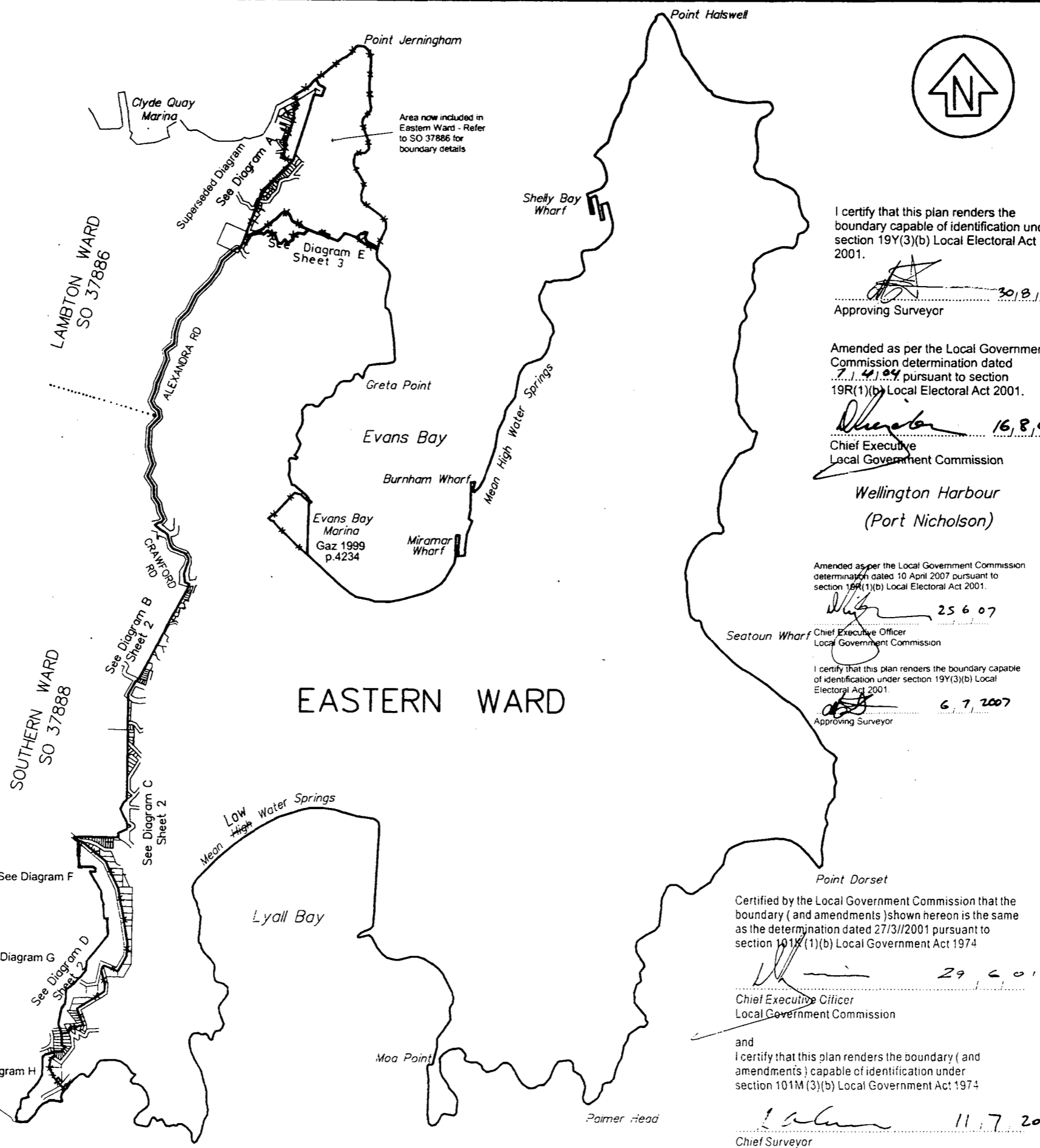

Diagram A
Not to scale
Superseded
Diagram
Refer to SO 37886

LAND DISTRICT Wellington
Survey Blk. & Dist.
NZMS 261 Sheet R27



EASTERN WARD

TERRITORIAL AUTHORITY Wellington City
Surveyed by Terralink NZ Limited
Scale 1 : 20 000 Date April 1998

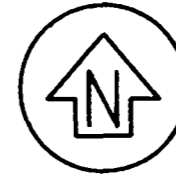

I certify that this plan renders the boundary capable of identification under section 19Y(3)(b) Local Electoral Act 2001.

[Signature] 30/8/2004
Approving Surveyor

Amended as per the Local Government Commission determination dated 7.1.04 pursuant to section 19R(1)(b) Local Electoral Act 2001.

[Signature] 16/8/04
Chief Executive
Local Government Commission

Wellington Harbour
(Port Nicholson)

Amended as per the Local Government Commission determination dated 10 April 2007 pursuant to section 19R(1)(b) Local Electoral Act 2001.

[Signature] 25/6/07
Chief Executive Officer
Local Government Commission

I certify that this plan renders the boundary capable of identification under section 19Y(3)(b) Local Electoral Act 2001.

[Signature] 6/7/2007
Approving Surveyor

Seaton Wharf
Local Government Commission

Certified by the Local Government Commission that the boundary (and amendments) shown hereon is the same as the determination dated 27/3/2001 pursuant to section 101M(1)(b) Local Government Act 1974

[Signature] 29/6/01
Chief Executive Officer
Local Government Commission

and
I certify that this plan renders the boundary (and amendments) capable of identification under section 101M(3)(b) Local Government Act 1974

[Signature] 11/7/2001
Chief Surveyor

Approvals

Note :

Where a boundary is shown along a river or road it follows the middle line of the physical river or legal road unless otherwise shown.

All seaward boundaries follow Mean High Water Springs but cross the mouths of all rivers, streams, inlets and estuaries except where shown otherwise.

Boundary change to mean low water springs as at 15 December 1998 see NZ Gazette 1998 p 476 5

[Signature]
Chief Surveyor 20/1/99
Certified by the Local Government Commission that the boundary shown hereon is the same boundary as per instructions dated 17 March 1998 pursuant to section 101(M)(1) Local Government Act 1974.

[Signature] (CEO) 1/5/98
Chief Executive Officer
Local Government Commission

Total Area

Comprised in

I, *[Signature]*, Registered Surveyor and holder of an annual practising certificate (or who may act as a registered surveyor pursuant to section 25 of the Survey Act 1986) hereby certify that this plan has been made from surveys executed by me or under my directions, that both plan and survey are correct and have been made in accordance with the Survey Regulations 1972 or any regulations made in substitution thereof.

Dated at _____ this _____ day of _____ 19 _____ Signature

Field Book p. _____ Traverse Book p. _____
Reference Plans

Examined _____ Correct

I certify that for the purposes of Section 101(M)(3)(b) Local Government Act 1974, this plan renders the boundaries of the Eastern Ward capable of identification.

[Signature]
Chief Surveyor

File \400201\egstern
Received 9/6/98
Instructions 400201.jv

SO 37887

