

Auckland Council
LG-076-2019-W-1

Thames-Coromandel
General Constituency
LG-03-2024-Con-2

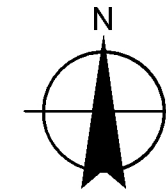

Notes:

1. Coordinates are in terms of New Zealand Transverse Mercator 2000 (NZTM).
2. Where a boundary is shown along a river or road it follows the middle line of the river or legal road unless otherwise shown.
3. Bearings shown are protracted in terms of true north and distances are scaled.

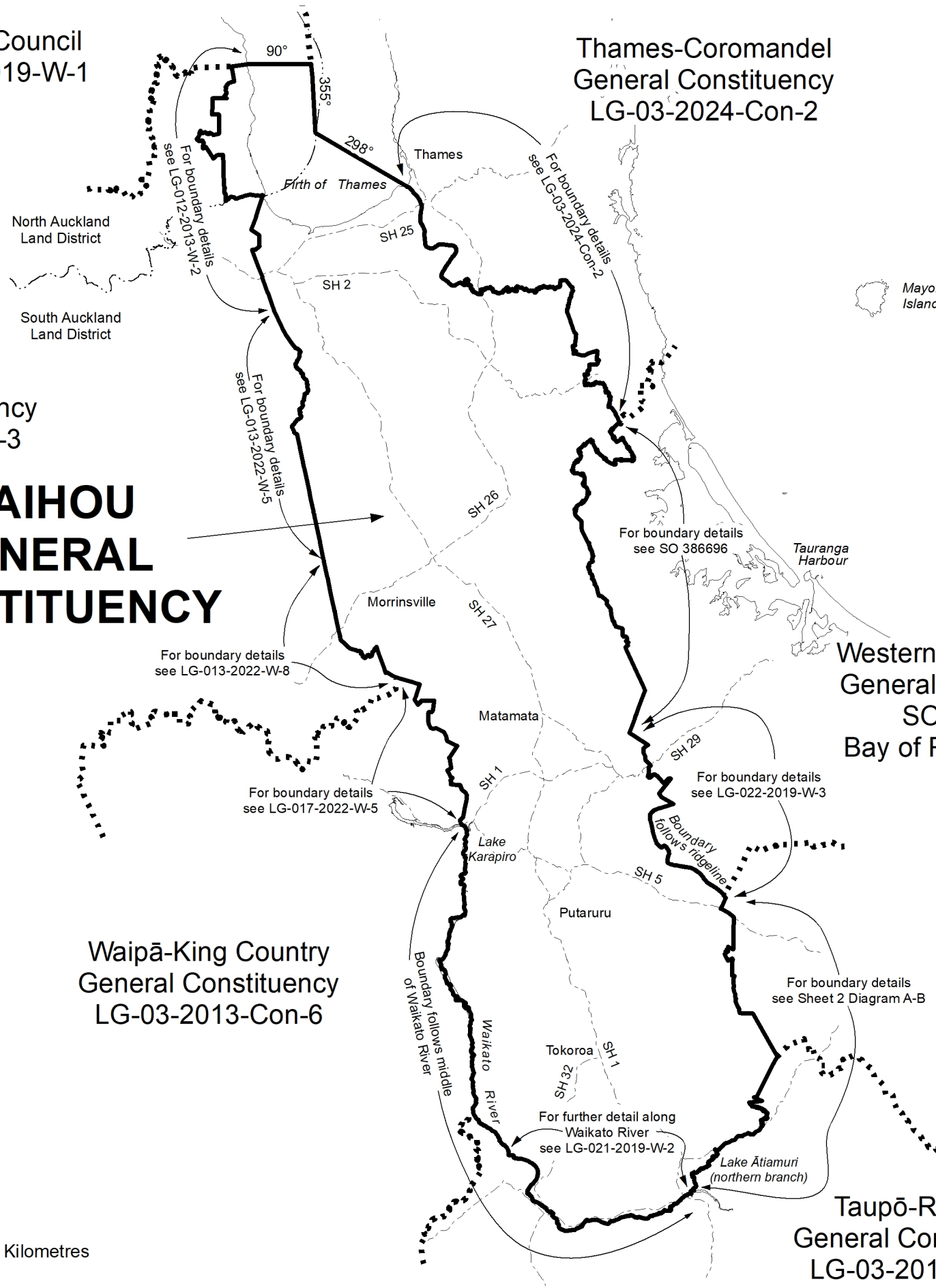

Waikato
General Constituency
LG-03-2013-Con-3

WAIHOU GENERAL CONSTITUENCY

Western Bay of Plenty
General Constituency
SO 386696
Bay of Plenty Region

Waipā-King Country
General Constituency
LG-03-2013-Con-6

Rotorua
General Constituency
SO 386695
Bay of Plenty Region

Taupō-Rotorua
General Constituency
LG-03-2013-Con-7

0 10 20 40 Kilometres

Land District: South Auckland -
North Auckland

WAIKATO REGION WAIHOU GENERAL CONSTITUENCY

TERRITORIAL AUTHORITY: Hauraki, South Waikato,
Matamata-Piako and
Rotorua, Districts

Compiled by Jacobs New Zealand Limited

Scale: 1:700,000 at A3

Date: October 2024

LG-03-2024-Con-3
Sheet 1 of 2

Notes:

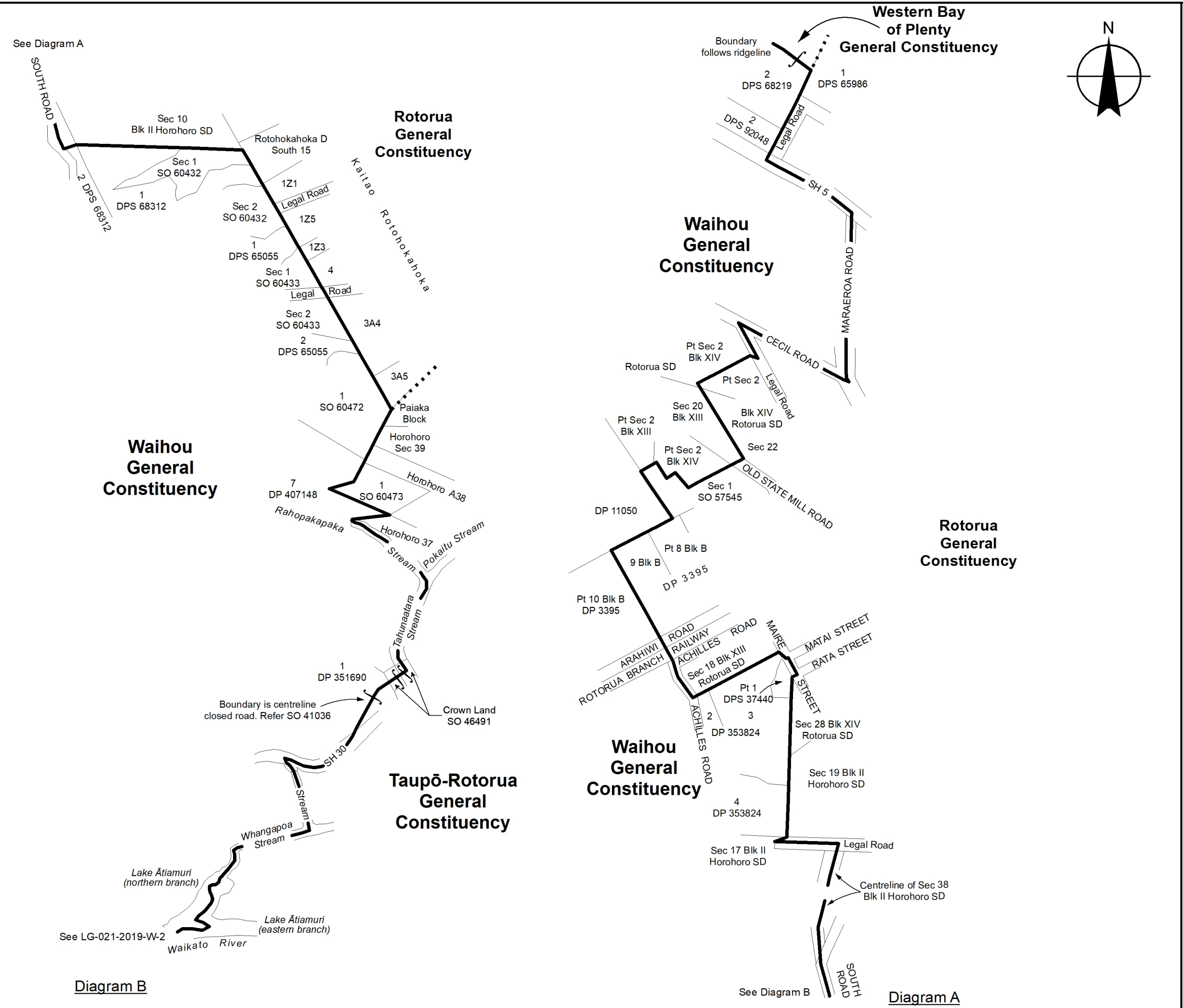
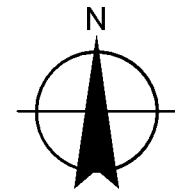

Diagram B

Diagram A

Land District: South Auckland - North Auckland

File: IZ0049800

WAIKATO REGION

WAIHOU GENERAL CONSTITUENCY

TERRITORIAL AUTHORITY: Hauraki, South Waikato, Matamata-Piako and Rotorua, Districts

Compiled by Jacobs New Zealand Limited

Scale: Not To Scale Date: October 2024

LG-03-2024-Con-3
Sheet 2 of 2